



ELECTRIC MOTORS



Vehicles



Marine



Hybrid



Robotics



Traction



Industrial



✓ EFFICIENT

✓ LIGHT

✓ POWERFUL

PERMANENT MAGNET DC ELECTRIC MOTORS

LIGHT WEIGHT

25kg Weight

EFFICIENT

Up to 93% efficiency

RELIABLE

Limited moving parts

ECO FRIENDLY

No emissions
No fuel

POWERFUL

Available from 24 to 110v

LOW COST

Save on fuel bills

MOTORS LEM-2X2

Overview

The LEM-200 is an axial gap DC brushed motor suitable for traction and industrial applications

Key Features

- Simple electronic control
- Long brush life
- Interchangeable shaft
- Rugged Construction
- CE Marked
- Ip20 rating
- Speed proportional to voltage

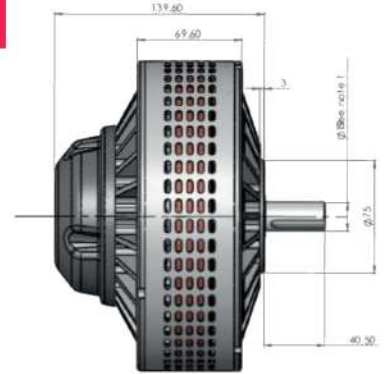

Typical Technical Data Curve

Data from LEM-200-D127

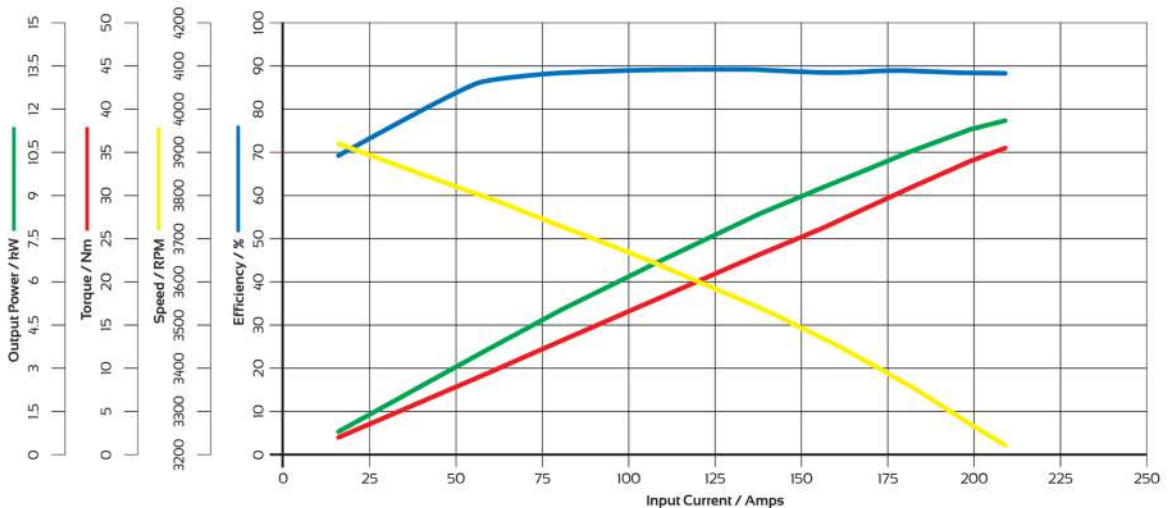

Applications



Industrial



Traction



ELECTRIC MOTORS

Lynch Motor Company Ltd.
 Unit 4 Flightway Dunkeswell, Honiton, Devon, EX14 4RD
 Tel: +0044 (0)1404 892940
 Fax: +0044 (0)1404 891990
 info@lynchmotors.co.uk

MOTORS LEM-2x2

The LMC-2X2 is a matched pair of axial gap DC brushed motor in a single frame suitable for traction and industrial applications.



✓ EFFICIENT ✓ LIGHT ✓ POWERFUL | PERMANENT MAGNET DC ELECTRIC MOTORS

Technical Data

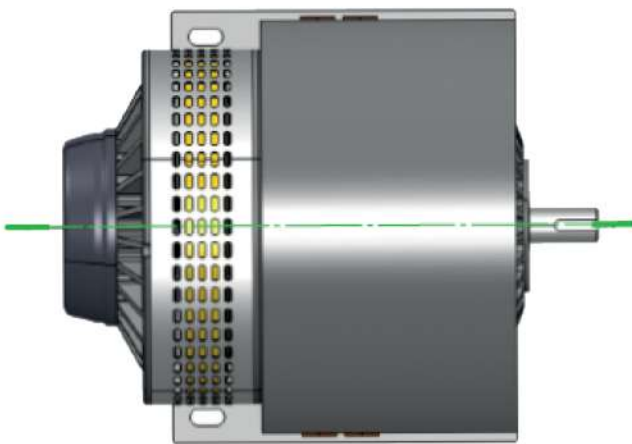
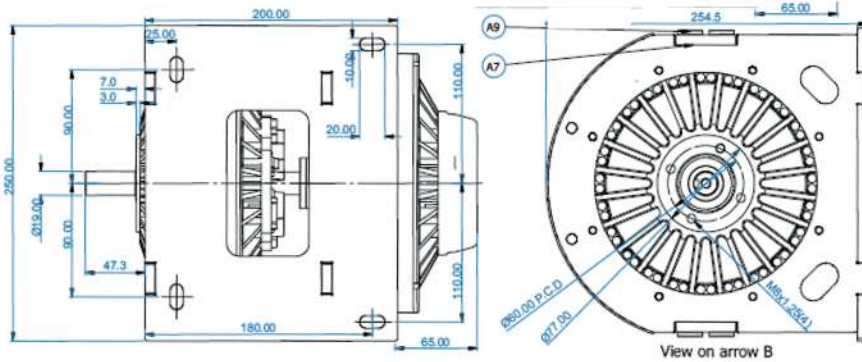

Label	QTY	Part No.	Description
A1	2	LEM 00054 A 00	LMC 20 Motor Assy
A2	2	LEM 00064 P	Motor Support plate
A3	1	LEM 00063 P	Base plate
A4	1	LEM 00064 P	Shaft coupler
A5	1	LEM 00065 P	Linking shaft
A6	1	LEM 00066 P	Cover
A7	2	LEM 00067 P	Side plate
A8	1	LEM 00068 P	Modified Brush Holder
A9	4	LEM 00069 P	Top Hat

Dimensions: MM

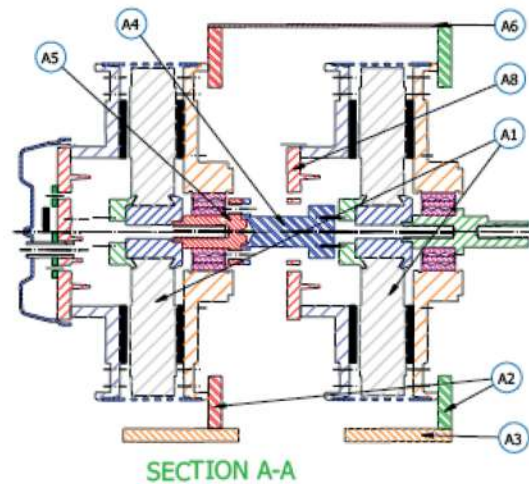

Additional Information

All Lynch motors come with a 2 year warranty and are fully tested before delivery to our customer. Each motor is built to order in our UK factory by our skilled team, lead times for orders are dependent on volume and current order book, please ask for a production time frame when ordering. We are happy to discuss your application requirements with you, any recommendations our team make are based on the information you provide us.